

# supersonic r

Dyson Supersonic r logo

## Dyson Supersonic r™ hair dryer User manual

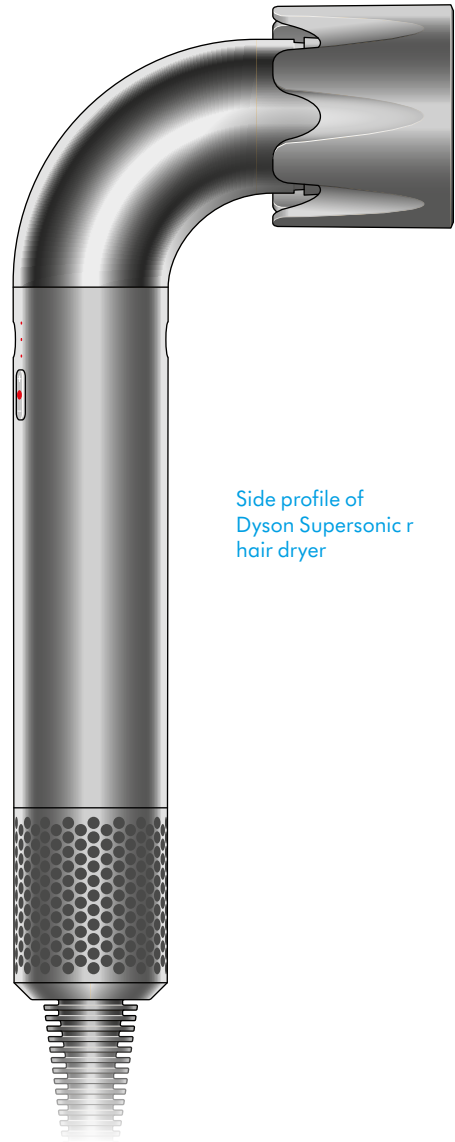

Side profile of  
Dyson Supersonic r™  
hair dryer

---

### Contents

In the box

Functions

Getting started

Using your Dyson Supersonic r™  
hair dryer

Taking care of your machine

**dyson** Dyson logo

# In the box

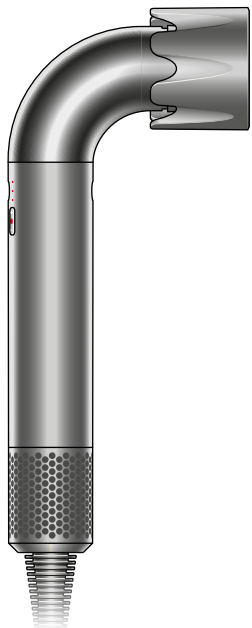

Side profile of Dyson Supersonic r hair dryer with all 5 attachments.

## Dyson Supersonic r™ hair dryer

Dyson's precision hair dryer for superior styling<sup>1</sup> and salon finish. Engineered as the lightest<sup>2</sup> and smallest<sup>3</sup> hair dryer in the range. Includes five Intelligent attachments.

---

You can buy additional attachments at [www.dyson.com](http://www.dyson.com).

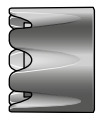

Powerful air attachment

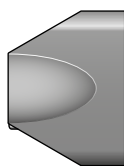

Pro concentrator

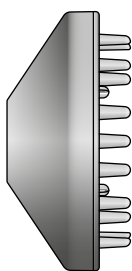

Diffuser

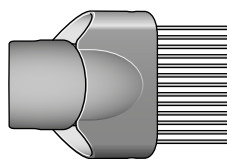

Wide-tooth comb attachment

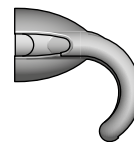

Flyaway attachment

# Functions

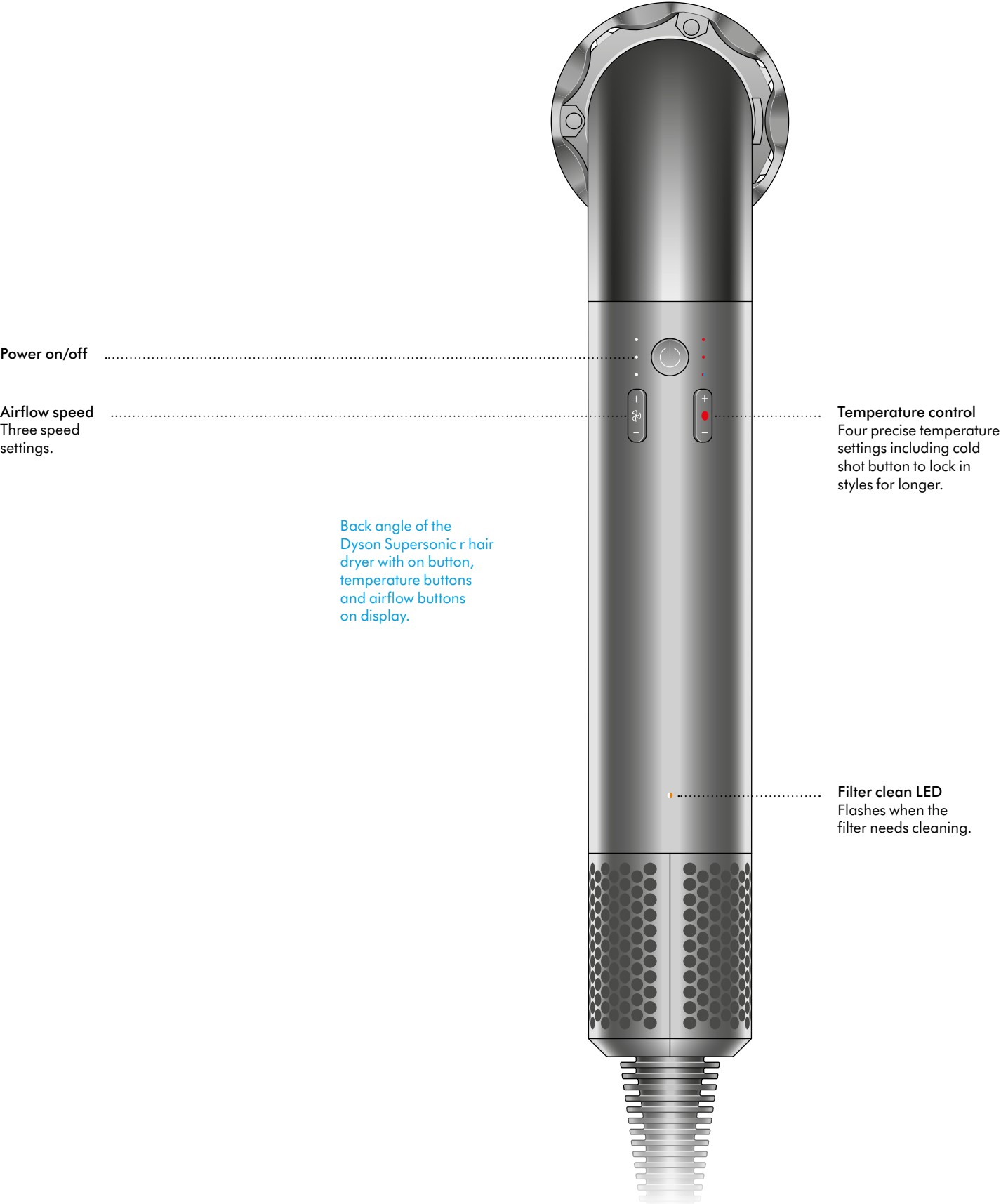

# Getting started

Remove machine from box

Plug in your machine

You must fit an attachment before switching on the machine in order for your hair dryer to work.

Attachment connected to machine with airflow being directed outwardly and a tick.

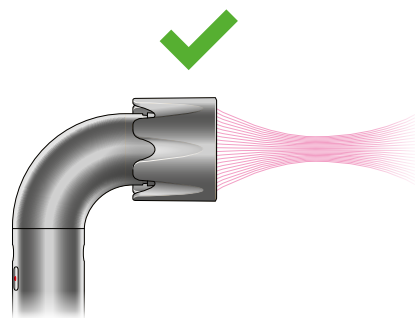

Attachment disconnected from the machine with a cross.

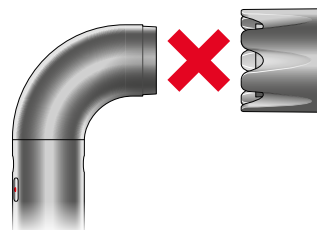

**Powerful air attachment**

Produces high-velocity airflow to dry hair fast.

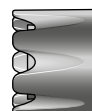

**Pro concentrator**

Focuses air precisely where you need it.

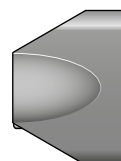

**Wide-tooth comb attachment**

Engineered to detangle and lengthen hair as it dries.

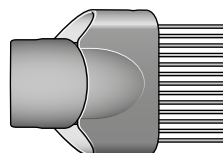

**Diffuser**

Helps reduce frizz<sup>1</sup> and define curls, coils and waves.

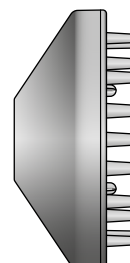

**Flyaway attachment**

Attracts longer hairs and hides flyaways on finished styles, using the Coanda effect.<sup>2</sup>

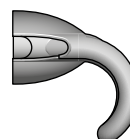

1. vs. air-dried hair. 2. For use on dry and straight[ened] hair.

# Using your hair dryer

## Settings

Intelligent attachments are preset with optimal airflow and temperature ranging, and recognize your last-used setting with Attachment learning.

## LEDs

LED colors indicate the four possible heat settings and three airflow settings.

---

### Airflow

Showing three circles for high airflow, two circles for medium airflow and one circle for low airflow.

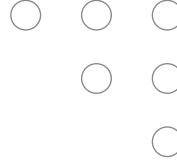

Fast

Medium

Gentle

---

### Temperature

Shows three red circles for high temperature, two red circles for medium temperature and one red circle for low temperature.



High

Medium

Low

Cool

---

### Diagnostics

#### Yellow flashing LED:

Your filter needs cleaning.



#### White flashing LED:

Your filter is either absent or not fitted properly. Ensure filter is fitted correctly for your hair dryer to work.



#### White-blue LEDs flashing:

There is no attachment fitted. Your machine will not work without an attachment.



#### All three white LEDs flashing:

Press the on/off button to clear an error.



#### All three red LEDs flashing:

Switch off your machine, switch off the mains plug and unplug your plug from the socket. Then, insert the plug back in the socket, switch the mains plug on and turn your machine back on.



#### All of the white and red LEDs flashing together:

Contact Dyson at 1-866-693-9766.



To learn how to clean your filter, follow the instructions or watch the video at <https://www.dyson.com/support/guides/supersonic-r>.

Shows different LED variants for different messaging from the machine for maintenance.

# Taking care of your machine

## Cleaning your filter

To maintain optimal performance of your hair dryer, clean your filter when prompted by the yellow flashing LED light, or if you feel reduced airflow. A white light flashes when the filter is absent or not properly fitted.

### Step 1

Unplug your machine from the electricity supply and allow to cool before cleaning your filter.

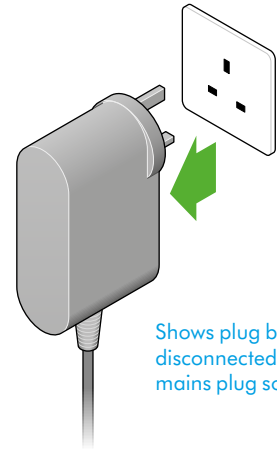

Shows plug being disconnected from the mains plug socket.

### Step 2

Remove the filter cage by sliding down the power cord and opening at the split line.

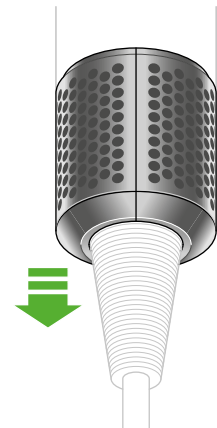

Shows filter being disconnected from the machine by sliding downwards.

### Step 3

Slide the two filter pieces away to separate.

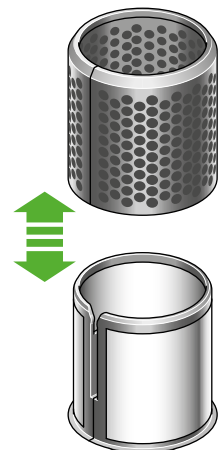

Shows filter cage and inner filter being separated.

**Step 4**

Wipe away any loose, large debris such as hair strands or large dust particles, from the filter cage.

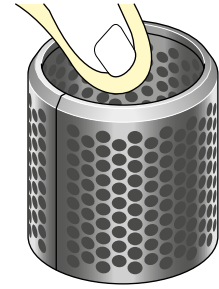

User wiping the filter casing from debris.

**Step 5**

Rinse the two filter parts under a warm running tap.

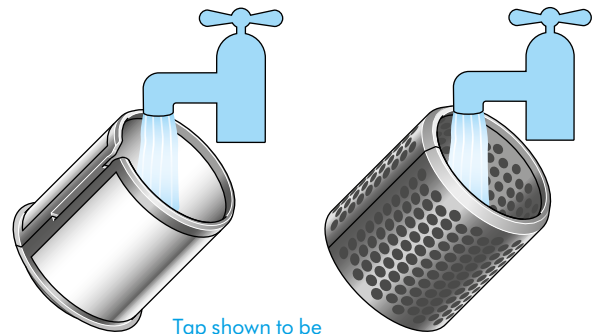

Tap shown to be washing the external and internal filter.

**Step 6**

Using a pea-sized amount of clarifying shampoo, lightly scrub the exterior of the inner filter cage in small, circular motions. Then, lightly scrub the interior of the inner filter cage with up and down motions before rinsing.

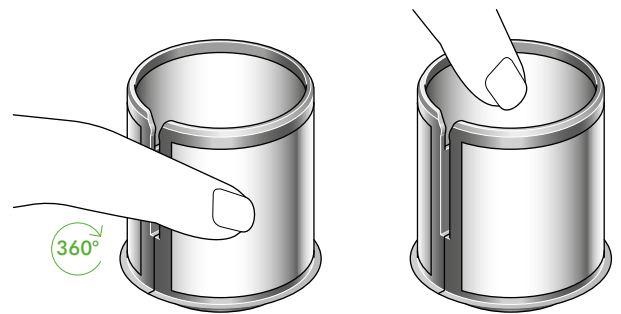

Finger rubbing in the shampoo to the internal filter.

**Step 7**

Hold up to the light to ensure there is no remaining debris or dirt.



Hand holding the internal filter up to the light.

**Step 8**

Using a pinching motion, gently squeeze dry the inner filter cage with a dry paper towel.

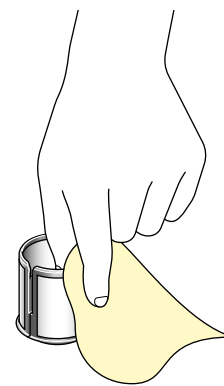

Hand shown to be wiping the internal filter and dabbing away dampness.

**Step 9**

Allow both filters to fully dry before proceeding.

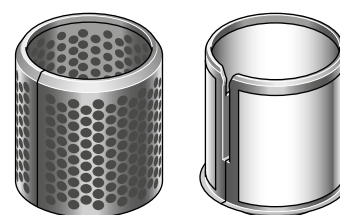

External and internal filter.

**Step 10**

Slide the inner filter back into the cage, then open at the split line and replace back on to the machine to click into place.

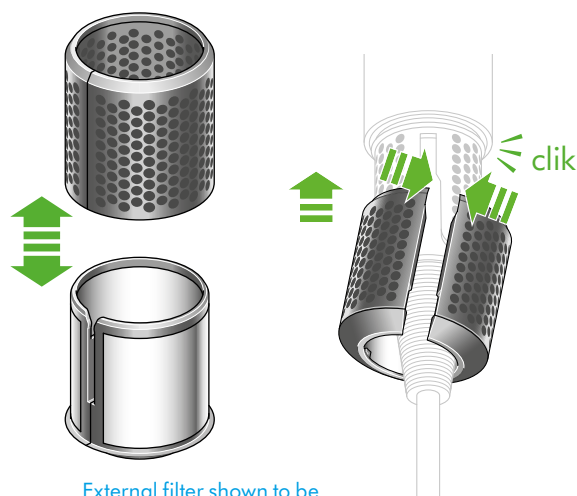

External filter shown to be reconnecting to the machine with a magnetic click demonstrated by arrows.

**White LED flashing:**

Your filter is either absent or not fitted properly. Ensure filter is fitted correctly for your hair dryer to work.

To watch how to clean and maintain your machine, visit <https://www.dyson.com/support/guides/supersonic-r>.

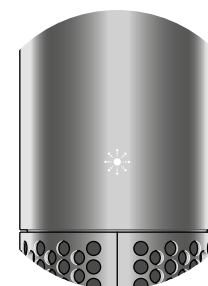

White light is flashing on the machine.